

100mm LONG INTERNAL BUTT STRAP, SEALED USING LOW MODULUS CLEAR SILICONE

CELOTEX 40mm X 50mm PIR INSULATION BOARD

TYPICAL TOP HAT BUTT DETAIL

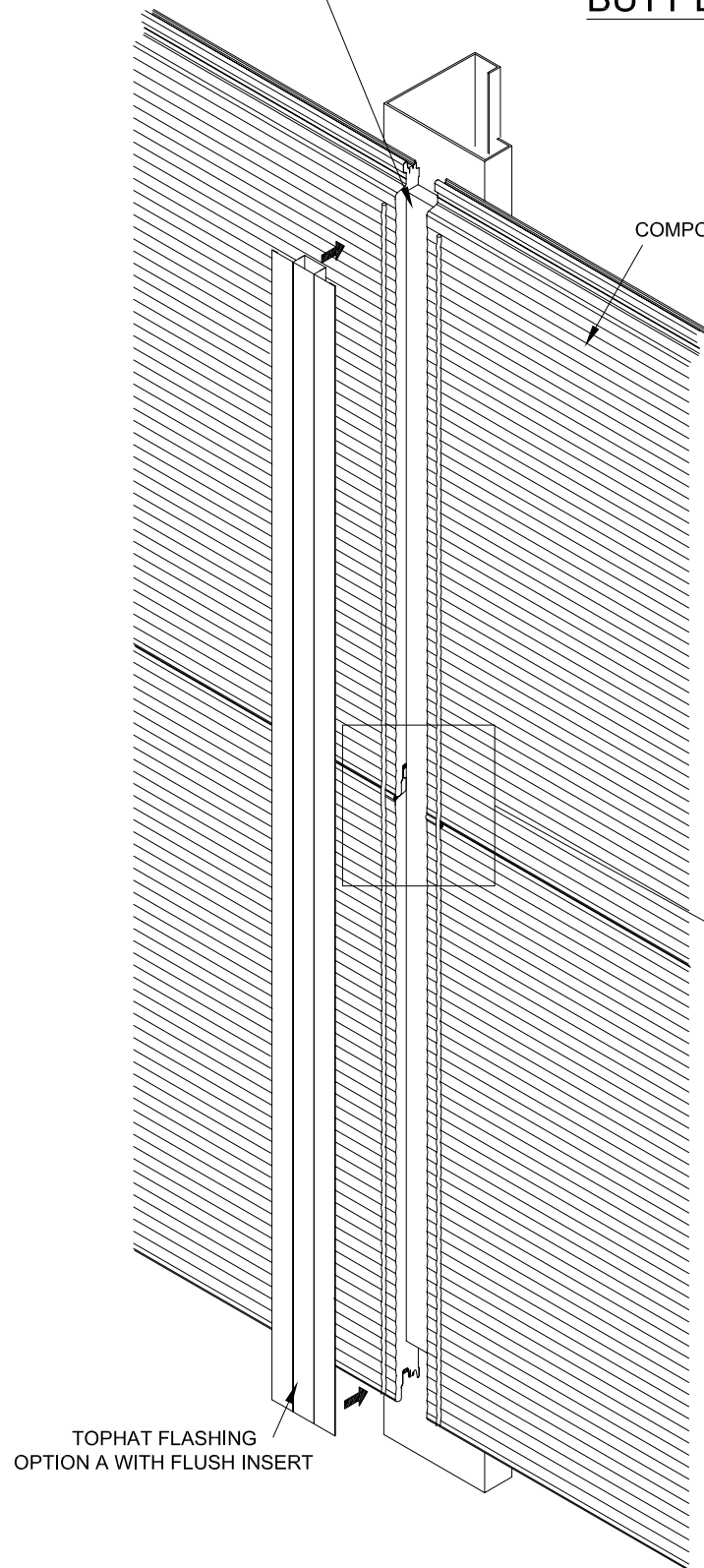

COMPOSITE WALL PANEL

TOPHAT FLASHING OPTION A WITH FLUSH INSERT

CELOTEX 40mm X 50mm PIR INSULATION BOARD ANY GAPS FILLED WITH CANISTER INSULATION ALFASBOND FIRE RATED (FR)

70mm COMPOSITE PANEL

70mm COMPOSITE PANEL

SITE APPLIED LM CLEAR SILICONE IN PANEL JOINT DURING PANEL INSTALLATION AND IN VOID - BEFORE TOP HAT FLASHING IS INSTALLED

1 CONTINUOUS RUN OF WHITE HP600 6 DIA BEAD BUTYL MASTIC BETWEEN PANEL & TOPHAT FLASHING. ADDITIONAL 15mm HORIZONTAL RUN OF BEAD TO BE APPLIED AT THE JOINT.

0.7mm STEEL PVF2 METALLIC SILVER OPTION A FLUSH INSERT TOPHAT FLASHING FIXED @ 1000 CENTRES USING DF3-HT G15-5.5 X 85

COMPOSITE PANEL FIXED USING CARBON STEEL DF3-HT G16-5.5 X 85

1 CONTINUOUS RUN OF GREY HP400 8 DIA BEAD BUTYL MASTIC BETWEEN PANEL & SECONDARY SUPPORT STEELWORK.

TYPICAL VERTICAL JOINT DETAIL

1 CONTINUOUS RUN OF WHITE HP600 6 DIA BEAD BUTYL MASTIC BETWEEN PANEL & TOPHAT FLASHING.

ADDITIONAL 15mm HORIZONTAL RUN OF BEAD TO BE APPLIED AT THE JOINT.

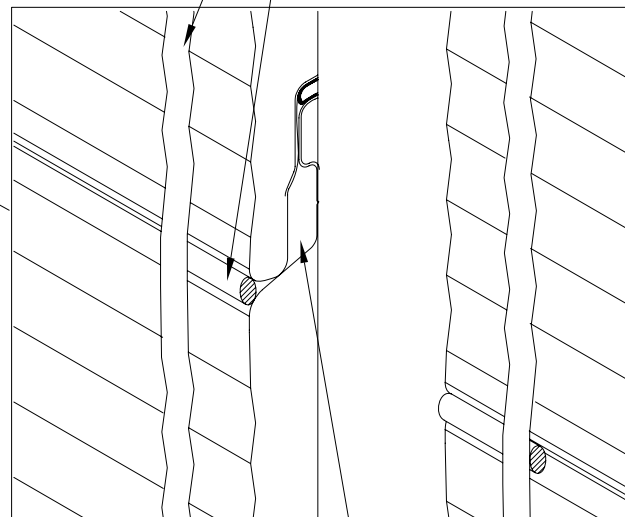

SITE APPLIED LM CLEAR SILICONE IN PANEL JOINT DURING PANEL INSTALLATION AND IN VOID - BEFORE TOP HAT FLASHING IS INSTALLED

TYPICAL MASTIC BEAD DETAIL AT VERTICAL PANEL JOINTS

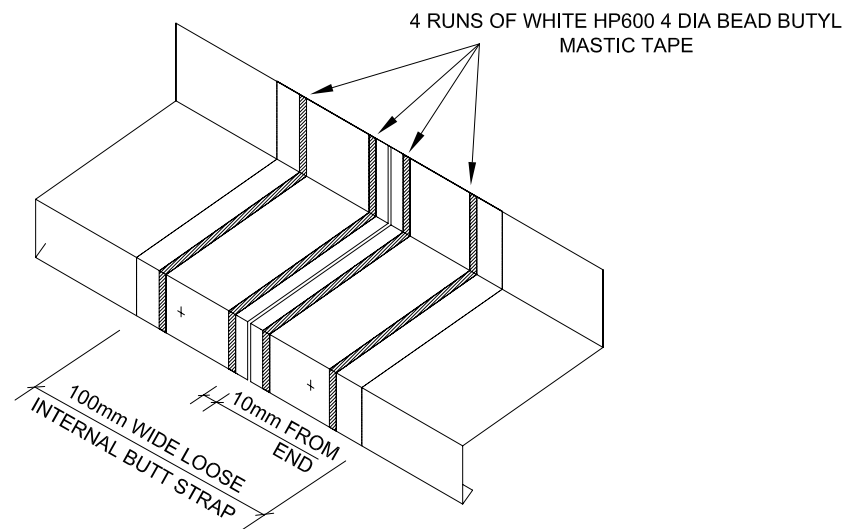

TYPICAL BUTT STRAP FLASHING JOINT

Rev :	Date :	Description :
A	26.03.04	ISSUED FOR CONSTRUCTION
.	09.03.04	ISSUED FOR APPROVAL
Client :		
TALBOT CONSTRUCTION LTD VOLVO, BASINGSTOKE		
Drawing Description :		
TOPHAT AND DRIP DETAILS		
Drawn by :	Date :	Project No. :
P.GUYTON	09.03.2004	C734
		Drawing No. :
		14
		Rev. :
		A

GALE CONSTRUCTION CO. LTD.
 Interline House
 Ayton Road Industrial Estate
 Wymondham Norfolk NR18 0QQ
 Telephone : (01953) 604537
 Facsimile : (01953) 602680